



**16 Holliday Close, Swindon, SN25 4YQ**

**Offers in excess of £319,000**

## Summary

NO ONWARD CHAIN.....Resides Swindon are delighted to be marketing this updated and spacious FOUR BEDROOM DETACHED property set in the sought after location of Abbeymeads. The hub of the home is the modern open plan kitchen/dining room with bi folding doors leading to the rear garden. This "wren" kitchen has a integrated dishwasher and fridge freezer with a gas hob and the worktops are a laminate luxury galaxy gloss. Also to the ground floor is a light and airy lounge and the downstairs WC. To the first floor is four bedrooms with an en suite to the main and built in wardrobes, family bathroom with separate shower cubicle. Other benefits is a landscaped low maintenance rear garden with a summer house. To the front is a blocked paved driveway that leads to the garage. EARLY VIEWINGS RECOMMENDED TO AVOID DISAPPOINTMENT.





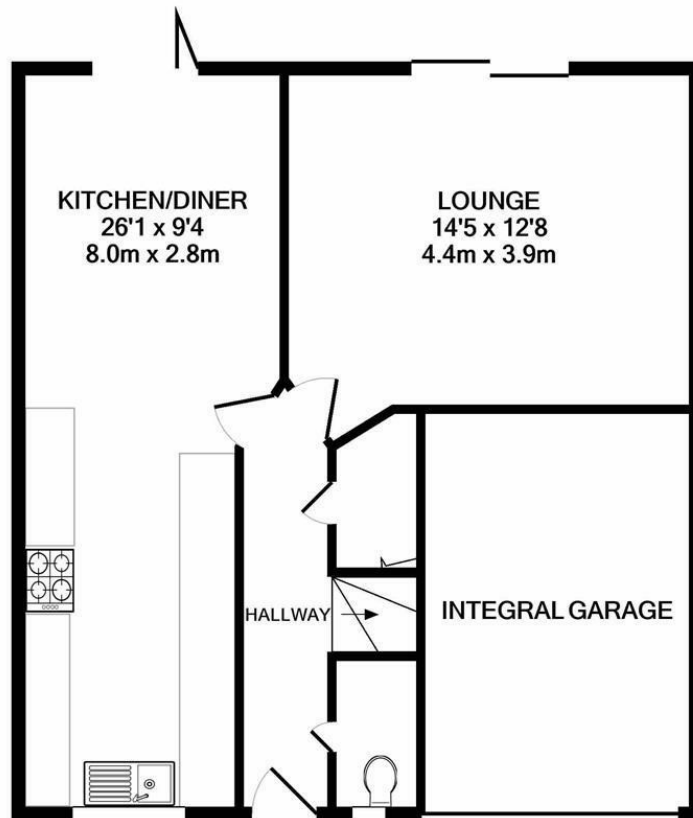

GROUND FLOOR

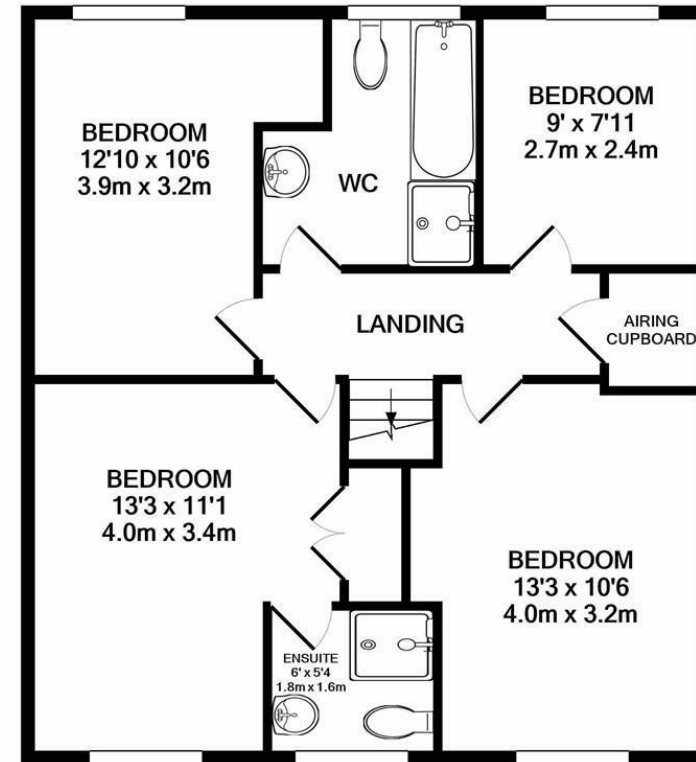

1ST FLOOR

Whilst every attempt has been made to ensure the accuracy of the floor plan contained here, measurements of doors, windows, rooms and any other items are approximate and no responsibility is taken for any error, omission, or mis-statement. This plan is for illustrative purposes only and should be used as such by any prospective purchaser. The services, systems and appliances shown have not been tested and no guarantee as to their operability or efficiency can be given  
Made with Metropix ©2020

